

# Txi-D

## USER GUIDE

### FEATURES

- Digital Signal Processing
- Beep Speed Control
- Digital Radio
- Variable LED brightness
- Stealth mode
- Instant Day/Night setting
- Mute function
- Advanced weather protection
- 64 Digital Tone Settings
- Auto power down
- Memorised User Preferences
- Smaller design

### OPERATION SUMMARY

- CONTROLS
- FITTING BATTERY
- SWITCHING ON/OFF
- QUICK START + DEFAULTS
- SET UP MODE
- ACTIVE SETTINGS
- ADVANCED SETTINGS
- RESET DEFAULTS
- BATTERY CONDITION
- WIRELESS RADIO USE
- RANGE TEST
- GUARANTEE & CARE

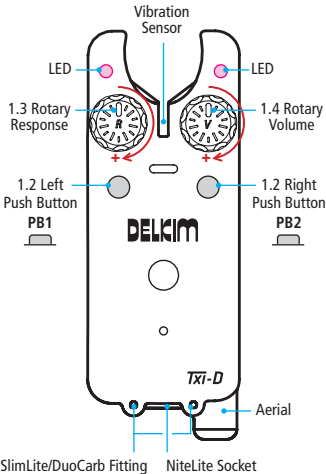

## OPERATING INSTRUCTIONS

### 1.0 CONTROLS & ATTACHMENTS

- VIBRATION SENSOR**
- PUSH BUTTONS - PB1 + 2 (left to right).**  
**Important** – Button presses are acknowledged by various intuitive confirmation tones and LED flashes.
- RESPONSE CONTROL (R)** – Previously known as sensitivity. Turn clockwise to increase the response of the vibration sensor to line movement. Important – use in conjunction with BEEP SPEED CONTROL (see 7.0).
- VOLUME CONTROL (V)** – Turn clockwise to increase level.
- NITELITE SOCKET** – Allows attachment of Delkim illuminated visual indicators. Note - if not to be used leave coloured bung in place.
- SLIMLITE/DUOCARB ATTACHMENT** – Two small holes at the base of the Txi-D allows attachment of wireform.

**WARNING** - Do not look directly at the LEDs or have the local speaker volume turned up to maximum when connecting a battery or switching on.

### 2.0 FIT BATTERY

**Do not use rechargeable batteries.** Use a good quality 9v battery such as a Duracell PP3. Completely remove the two screws using the tool provided. Lift off the battery cover. Attach the battery and refit cover. Replace the screws being careful not to over tighten.

**Note** - When a battery is connected to a Txi-D for the first time it will switch ON automatically.

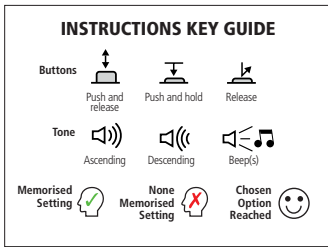
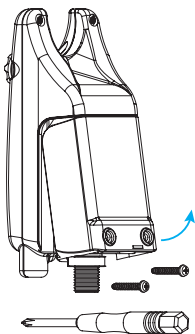

### 3.0 SWITCHING ON/OFF

The Txi-D requires a two push button press to switch ON/OFF. Hold down **PB1+2** together until confirmation tones are heard and immediately release. DO NOT keep holding down buttons after switch ON or Set Up Mode (see 5.0) will be entered.

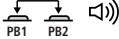

**Note** – Switching OFF always transmits an alert signal to the Rx-D which will trigger the Anti-Theft Security Alarm if it is enabled (See Rx-D User Guide 9.0).

### 4.0 FACTORY DEFAULT SETTINGS

Basic settings that allow immediate use. Switch ON - Adjust Volume & Response to required levels - Start Fishing – For wireless use see Rx-D User Guide.

**TONE – MEDIUM**  
**LED MODE – NIGHT (+ Night Marking)**  
**SPEED – MEDIUM (4)**  
**IMU (Movement Sensor) – OFF**

### 5.0 SET UP MODE

(Normally carried out before fishing)

Allows tone adjustment and Stealth LED mode to be set. First make sure Txi-D is switched OFF Switch ON keeping both **PB1+2** held down for start up tones. Wait for two confirmation tones and immediately release both buttons simultaneously. **Set up mode will automatically time out within 10 seconds from the last PB press.**

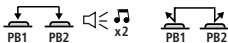

- 5.1 TONE ADJUST** – Select required tone by pressing and holding **PB1** whilst in set up mode to cycle through the 64 tones. Releasing and pressing **PB1** again reverses the direction of tone change. Release **PB1** when required tone is reached. To repeat the set tone during adjust mode simply press and release **PB1** as often as required. Once set simply wait until set up mode times out and the selected tone will be memorised.

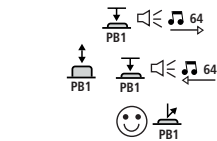

- 5.2 STEALTH LED MODE** – This is a special night setting for Delkim illuminated visual indicator users or used as a Stealth Mode. When set the internal LEDs no longer flash and latch but Night Marking is ON. The LED in the Delkim illuminated visual indicator lights up as normal with activation giving a stunning visual effect. Press **PB2** to toggle Stealth LED mode ON/OFF. This only alters the night LED mode and keeps Night Marking ON. Day mode remains unchanged. The LED brightness may be adjusted (see 9.0).



### ACTIVE SETTINGS

Set using one PB whilst in use.

### 6.0 MUTE ON/OFF

Mutes local Txi-D speaker only. Press **PB1** and release as soon as single confirmation tone is heard. **Do not continue to hold down PB1 or beep speed will be changed.** Mute will stay ON for 5 minutes with the left hand LED flashing as a visual reminder that it is set after a brief delay. Mute may be cancelled at any time with a single press of **PB1**. **Not memorised**



**Note** - when mute is set to ON all **PB2** actions are barred.

### 7.0 BEEP SPEED CONTROL

Allows the Beep Speed to be set to personal preference totally independently from the response level. Press and continue to hold **PB1** after the single Mute confirmation tone is heard to cycle through the 8 speed levels from 1-8 (slow to fast). Release **PB1** at required speed. When speed 8 is reached it is confirmed by continual repetition of the info tone. To reset simply repeat the process. **Important** – Use in conjunction with the rotary Response (R) control to get optimum bite indication. **Memorised setting**



### 8.0 DAY/NIGHT LED MODES

Selects Day (default level 8) or Night (default level 4) LED brightness with Night Marking. A single press and release of **PB2** toggles between Day/Night. **Last setting memorised**



**Note** - Night mode always has Night Marking.

### 9.0 LED BRIGHTNESS ADJUST

Allows LED brightness to be set to personal preference in both Day/Night modes. **First select the Day/Night mode to be adjusted.** Press and hold **PB2** to cycle through the 8 brightness levels from 1 – 8 (min – max). Release **PB2** at required brightness. When brightness 8 is reached it is confirmed by continual repetition of the info tone. To reset simply repeat the process. **Memorised setting**



### ADVANCED SETTINGS

Requires Txi-D to be switched OFF and back ON pressing two **PBs**.

### 10.0 IMU (MOVEMENT SENSOR)

This gives an additional layer of security in vulnerable situations where moving the Txi-D will transmit an alert message to the Rx-D. To enable first make sure Txi-D is switched OFF. Switch ON keeping both buttons pressed down. Wait for ON confirmation tones then release **PB2** keeping **PB1** pressed until the confirmation tones are heard then release **PB1**.



**Note** – It takes up to 10 seconds from enabling for the IMU to stabilise. **Session only setting not memorised** – always reverts to IMU disabled after switch OFF. When the IMU is enabled and security is set on the Rx-D be aware that the anti-theft alarm may be accidentally triggered by moving the Txi-D.

### 11.0 RANGE TEST

When enabled the Txi-D pulses continuously with a series of tones to check the reception of the Rx-D. First make sure Txi-D is switched OFF. Switch ON keeping both buttons pressed down. Wait for ON tones then release **PB1** keeping **PB2** pressed until the confirmation tone is heard then release. The Txi-D will pulse continuously. Range test is cancelled by a quick press of either button. **Never memorised**



**Note** – Always carry out a range test using a full set up with rods, Visual Indicators etc. in place for a realistic test. Actual range will vary depending on bankside and ambient conditions and whether Standard, Boost or Short Range is set on the Rx-D. (See Rx-D User Guide 6.0 – 6.3)

### 12.0 RESET TO FACTORY DEFAULTS

First Switch OFF - Switch ON and keep holding both **PBs** down for 2 beeps, then 3 beeps and immediately release. Press and hold **PB1** for sequence until the Txi-D Switches OFF. This restores all of the settings to the Factory Defaults (See 4.0)

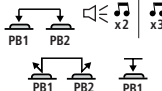

### 13.0 WARNINGS & ALERTS

- 13.1 BATTERY CONDITION** - The battery condition is tested at switch ON and after each activation. If it is found to be low it gives a distinctive double descending tone warning that is also transmitted to the Rx-D. Replace the battery as soon as possible. Replacing a battery - Disconnect the battery and press both **PBs** for 2 seconds. Fit the replacement battery and the Txi-D will switch ON automatically. Replacing a battery does not affect anything memorised.

- 13.2 AUTO SWITCH OFF (Power Saving)** - When switched ON if no activity is detected within approximately 48 hours the Txi-D will switch OFF with audible countdown warning tones. Press any **PB** to extend period for another 48 hours.

- 13.3 PB FAILSAFE ABORT** – If all or any **PBs** become held down continuously by accident the Txi-D will assume a fault state and switch OFF automatically.

### 14.0 WIRELESS RADIO USE

To use wirelessly the Txi-Ds must first be Paired with the Rx-D. See Rx-D instructions for Easy Pairing (4.0). Range may be reduced if the Txi-D is positioned close to the ground or near any large metal objects. Keep the Txi-D at least half a metre away from all electrical devices and the Rx-D.

### 15.0 GUARANTEE & CARE GUIDELINES

Txi-Ds come with a 2 year guarantee as standard (3 years with registration). Txi-Ds do not need servicing. Look after them and they will look after you.

- After use in rain clean and store upright in a warm place to dry with the hard cases removed.
- If a Txi-D becomes immersed in water, switch OFF, remove the battery and shake out any water. Store in a warm place to totally dry out.
- Tampering with any screws other than to remove the battery door or treating with any substance **particularly WD40** will invalidate any guarantee.

Full terms and conditions of our guarantee, registration, after sales care and best practice can be found on our website. [www.delkim.co.uk](http://www.delkim.co.uk)